

**General Specifications**

Case: 300 series stainless steel

Ring: 300 series Stainless steel, bayonet type

Lens: Polycarbonate

Dial: Aluminum, white finished with black markings

Pointer: Aluminum, black, micro-adjustable

Movement: Brass, rotary type

Tube: Phosphor bronze

Socket: Brass

Connection: 1/4"NPT lower mount

Accuracy: ±1.0% full scale ASME B40.100 Grade 1A

Process Temp:

P4098LY Dry, -40 to 200°F

PLF4098LY Glycerine Filled, 0 to 140°F

PSF4098LY Silicone Filled, -40 to 140°F

STANDARD RANGE		GRADUATIONS	
Code	Range	Fig.	Div.
001	30"hg-0psi	5	1
002	30"-0-15psi	10/5	2/1
003	30"-0-30psi	10/5	2/1
004	30"-0-60psi	10/10	1/1
005	30"-0-100psi	30/20	5/2
006	30"-0-150psi	20/20	5/5
008	30"-0-300psi	30/50	5/2
02	0-15psi	2	0.5
03	0-30psi	5	1
04	0-60psi	10	1
05	0-100psi	10	1
06	0-160psi	10	1
07	0-200psi	20	2
08	0-300psi	50	5
10	0-600psi	50	10
11	0-1,000psi	100	10
19	0-1,500psi	200	10
12	0-2,000psi	200	10
13	0-3,000psi	500	10
14	0-5,000psi	500	50
16	0-10,000psi	1000	100
17	0-15,000psi	2000	100
18	0-20,000psi	2000	200

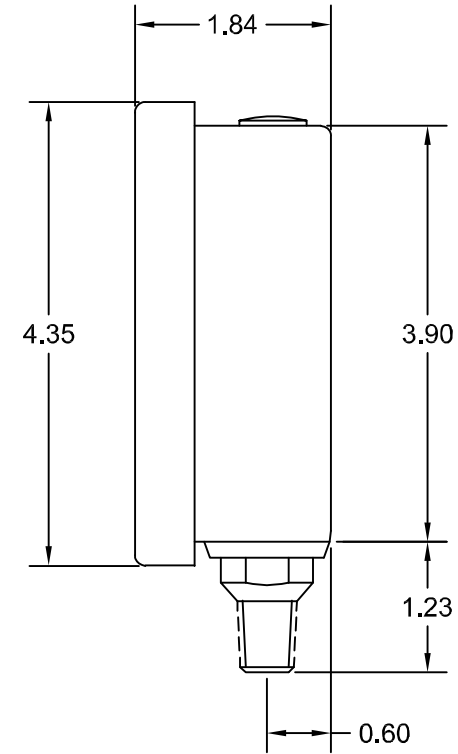
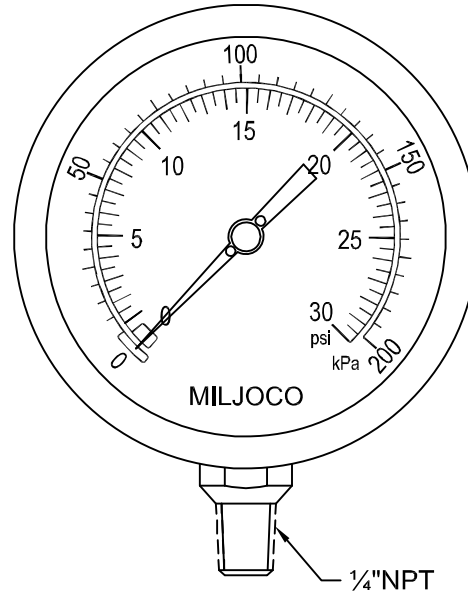

Customer: \_\_\_\_\_

Project: \_\_\_\_\_

Engineer: \_\_\_\_\_

Pro or PO#: \_\_\_\_\_

**MILJOCO**

CORPORATION 200 Elizabeth Street, Mt. Clemens, Michigan 48043 USA

SCALE: None	APPROVED BY:	DRAWN BY: HMT
DATE: 5/11/05		REVISED:

**4.0" Industrial Pressure Gauge**

.XX ± .010	.XXX ± .005	MODEL NUMBER: P4098LY Series	DRAWING NUMBER: 127-110A
------------	-------------	------------------------------	--------------------------