

# BIMETAL THERMOMETER

## 2" Rear Connection

Miljoco 2" Rear Connected Bimetal Thermometers feature a compact design and economical price. These tamper-proof instruments are an excellent choice when an external recalibrator or pointer adjustment are not required. The hermetically-sealed, stainless steel case prevents moisture from entering into the instrument and fogging the lens, thus allowing the operator to obtain clear, accurate readings.

### General Specifications

- CASE & RING:** Hermetically sealed 300 series stainless steel.
- LENS:** Double strength glass standard, with polycarbonate (250°F maximum range) optional.
- DIAL:** Aluminum with white finish and black markings.
- POINTER:** Black.
- RECALIBRATOR:** None.
- CONNECTION:** 300 series stainless steel, 1/4" NPT.
- STEM:** 300 series stainless steel, Ø 0.250".
- ACCURACY:** ±1% full range (ASME B40.3 Grade A).
- AMBIENT TEMPERATURE:** -40 to 250°F (-40 to 120°C).

#### NSF® Service

Many Miljoco thermometers are listed by NSF® for use in the food service industry. Consult factory for available models and ranges.



B2098

### Models & Dimensions (in.)

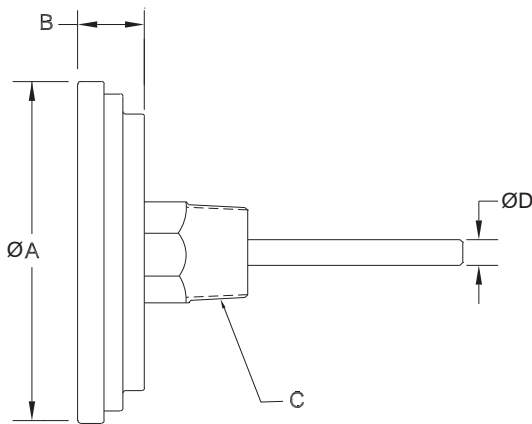

Model	Dial Size	Lens	A	B	C	D
B2099	2"	Glass	2.15	0.675	¼" NPT	0.250
B2098	2"	Polycarb.	2.15	0.675	¼" NPT	0.250

### Ranges

Range Code	Range	°F Scale		°C Scale	
		Fig.	Div.	Fig.	Div.
39	-40 to 160°F / -40 to 70°C	20°	2°	10°	1°
43	25 to 125°F / -5 to 50°C	10°	1°	5°	.5°
54	0 to 250°F / -20 to 120°C	50°	2°	20°	2°
63	50 to 300°F / 10 to 150°C	50°	2°	20°	2°
94	50 to 500°F / 10 to 260°C	50°	2°	20°	2°
65	150 to 750°F / 50 to 400°C	100°	10°	50°	5°
59	200 to 1000°F / 100 to 530°C	100°	10°	50°	5°

Other ranges may be available - consult factory.

### Stem Lengths

Stem Length "U" (in.)					
Code	2	4	6	9	12
Dim.	2.50	4.00	6.00	9.00	12.00

Other stem lengths available - consult factory.

### To Order

**B 2 0 9 8**      **5 4**      -      **2**  
 Model Number      Range      Stem  
                                  Code      Length

### Options

- Glass Lens (Model B2099)

