

General Specifications

Case: 300 series stainless steel

Ring: 300 series Stainless steel, bayonet type

Lens: Polycarbonate

Dial: Aluminum, white finished with black markings

Pointer: Aluminum, black, micro-adjustable

Movement: Stainless steel, rotary type

Tube & Socket: 316 stainless steel

Connection: 1/4"NPT or 1/2"NPT lower mount

Accuracy: ±1.0% full scale ASME B40.100 Grade 1A

Process Temp:

P4098LYSS Dry, -40 to 250°F

PLF4098LYSS Glycerine Filled, 0 to 140°F

PSF4098LYSS Silicone Filled, -40 to 140°F

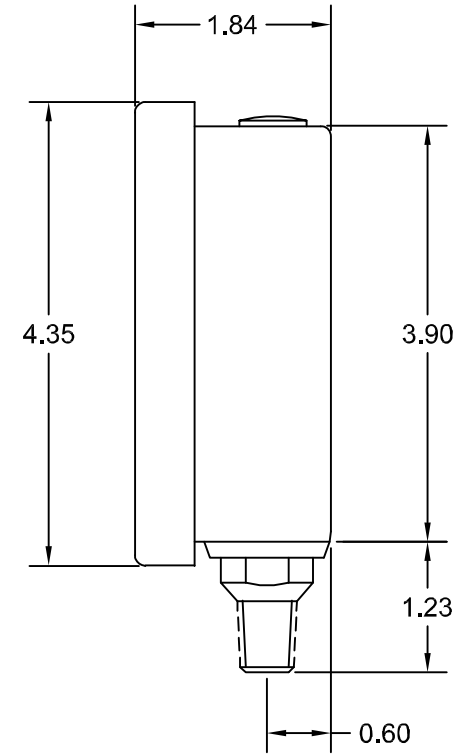
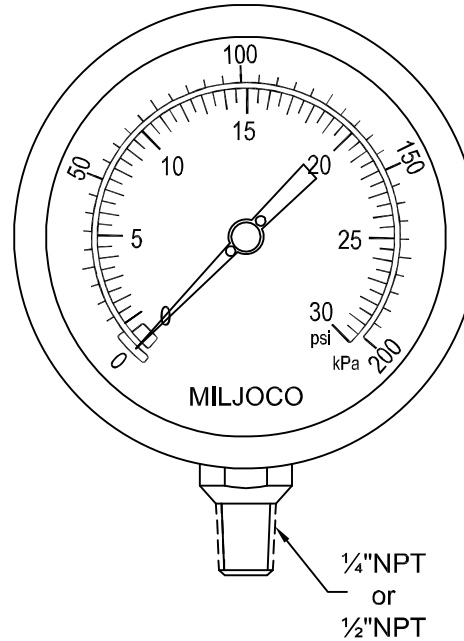

PSI Range Specifications			
Code	Range	Fig.	Div.
001	30"Hg-0psi/kPa	10/5	1
002	30"-0-15psi/kPa	10/5	2/1
003	30"-0-30psi/kPa	10/5	2/1
004	30"-0-60psi/kPa	10/10	1/1
005	30"-0-100psi/kPa	30/20	5/2
006	30"-0-150psi/kPa	30/20	5/2
008	30"-0-300psi/kPa	30/50	10/10
02	0-15psi/kPa	2	0.1
03	0-30psi/kPa	5	1
04	0-60psi/kPa	10	1
05	0-100psi/kPa	10	1
06	0-160psi/kPa	20	2
07	0-200psi/kPa	20	2
08	0-300psi/kPa	50	5
09	0-400psi/kPa	50	5
10	0-600psi/kPa	50	10
11	0-1000psi/kPa	100	10
19	0-1500psi/kPa	200	10
12	0-2000psi/kPa	200	10
13	0-3000psi/kPa	500	10
14	0-5000psi/kPa	500	50
16	0-10000psi/kPa	1000	100
17	0-15000psi/kPa	2000	100
18	0-20000psi/kPa	2000	200

Customer: _____

Project: _____

Engineer: _____

Pro or PO#: _____

MILJOCO

CORPORATION 200 Elizabeth Street, Mt. Clemens, Michigan 48043 USA

SCALE: None	APPROVED BY:	DRAWN BY: HMT
DATE: 7/28/14		REVISED:

4.0" Industrial Pressure Gauge

.XX ± .010	.XXX ± .005	MODEL NUMBER: P4098LYSS Series	DRAWING NUMBER: 127-110
------------	-------------	--------------------------------	-------------------------