

General Specifications

- Case: Series stainless steel
- Ring: Crimped stainless steel
- Lens: Acrylic
- Dial: Aluminum, white finished
black markings
- Pointer: Aluminum, black
non-adjustable
- Movement: Brass with precision
milled teeth
- Tube & Socket: Brass
- Connection: Brass, 1/4"NPT
- Fill: Glycerine
- Accuracy: ±3-2-3% full scale
- ASME B40.100 Grade A
- Process Temp: 0 to 140°F
- Ambient Temp: 0 to 140°F

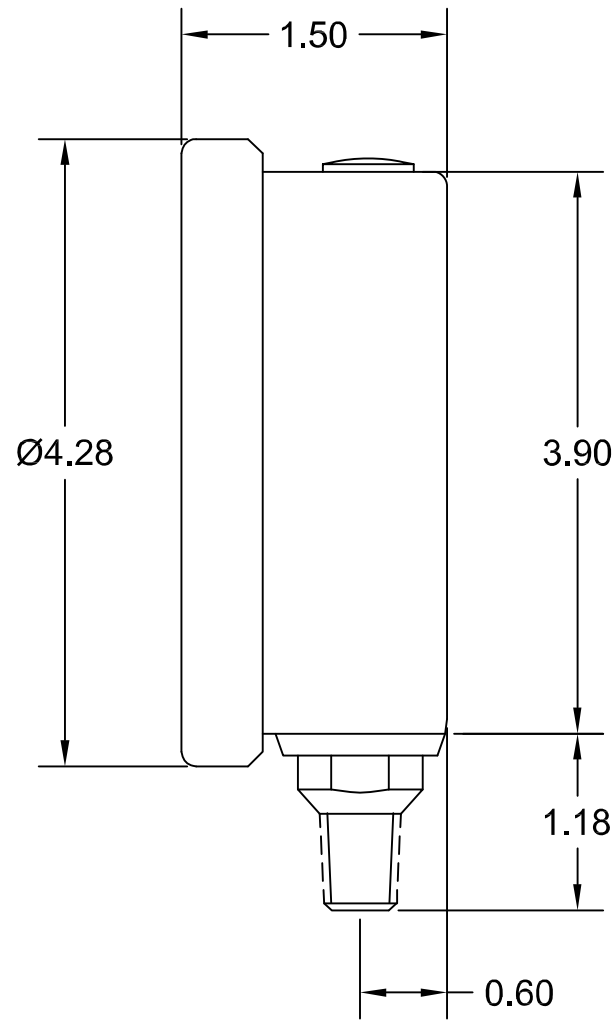
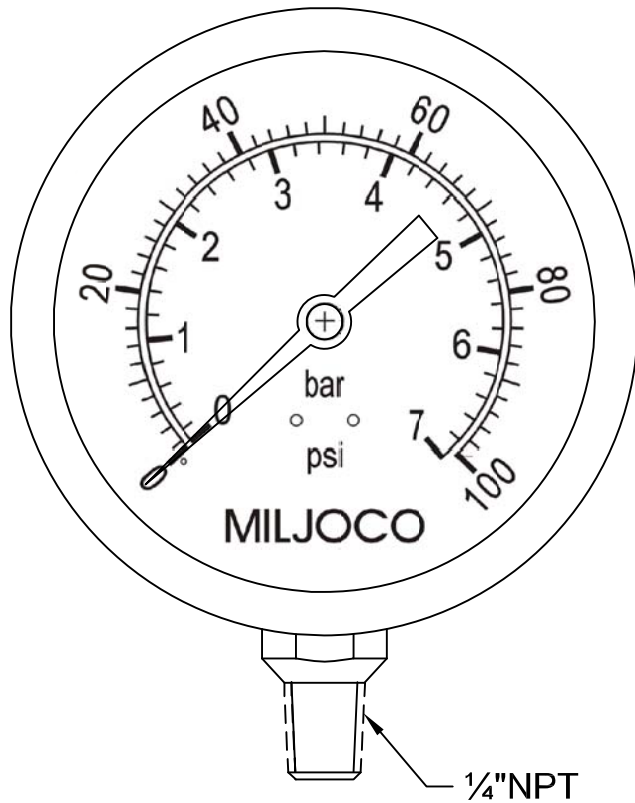

Customer: _____

Project: _____

Engineer: _____

Pro or PO#: _____

MILJOCO			
CORPORATION 200 Elizabeth Street, Mt. Clemens, Michigan 48043 USA			
SCALE:	None	APPROVED BY:	DRAWN BY: HMT
DATE:	8/5/14		REVISED:
4.0" Glycerine Filled Pressure Gauge			
.XX ± .010	.XXX ± .005	MODEL NUMBER: PLF4098L Series	DRAWING NUMBER: 127-329