

Model	Body Material	Conn. Size	Maximum Pressure	Service
1200-25-B-1	Brass	1/4" NPT	1000 psi	Air & Other Gases
1200-25-B-2	Brass	1/4" NPT	1000 psi	Water & Light Oils
1200-25-B-3	Brass	1/4" NPT	1000 psi	Heavy Oils
1200-25-SS-1	303SS	1/4" NPT	2000 psi	Air & Other Gases
1200-25-SS-2	303SS	1/4" NPT	2000 psi	Water & Light Oils
1200-25-SS-3	303SS	1/4" NPT	2000 psi	Heavy Oils
1200-50-B-1	Brass	1/2" NPT	5000 psi	Air & Other Gases
1200-50-B-2	Brass	1/2" NPT	5000 psi	Water & Light Oils
1200-50-B-3	Brass	1/2" NPT	5000 psi	Heavy Oils
1200-50-SS-1	303SS	1/2" NPT	5000 psi	Air & Other Gases
1200-50-SS-2	303SS	1/2" NPT	5000 psi	Water & Light Oils
1200-50-SS-3	303SS	1/2" NPT	5000 psi	Heavy Oils

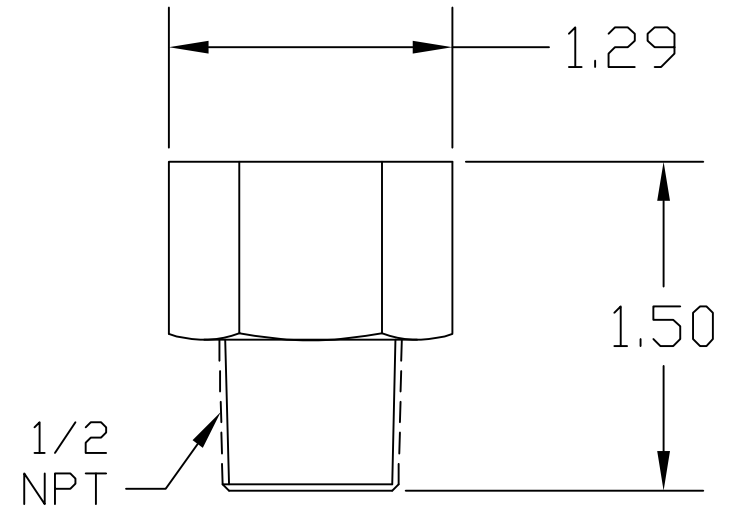
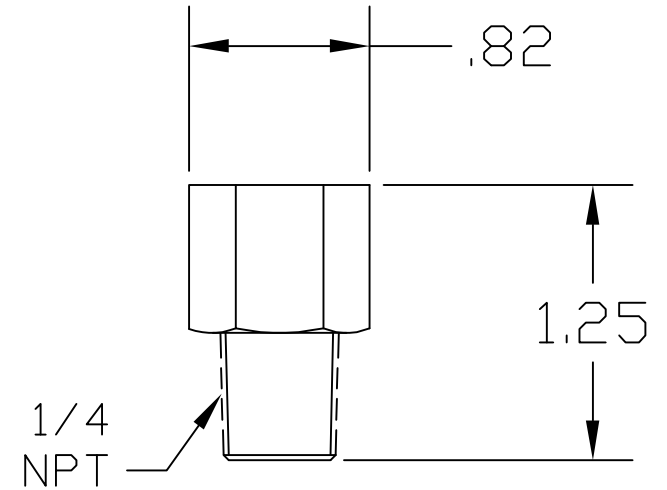

Customer: _____

Project: _____

Engineer: _____

Pro or PO#: _____

MILJOCO

CORPORATION 200 Elizabeth Street, Mt. Clemens, Michigan 48043 USA

SCALE: None

APPROVED BY:

DRAWN BY: HMT

DATE: 10/10/11

REVISED:

Snubber 1/4" NPT and 1/2" NPT

.XX ± .010

.XXX ± .005

MODEL NUMBER:

1200 series

DRAWING NUMBER:

127-219