

General Specifications

Case: 300 series stainless steel
 Ring: Crimped, 300 series stainless steel
 Lens: Acrylic
 Dial: Aluminum, white finished black markings
 Pointer: Aluminum, black non-adjustable
 Movement: Brass with precision milled teeth
 Tube & Socket: Brass
 Connection: 1/4"NPT bottom outlet
 Fill: Glycerine
 Accuracy: ±3-2-3% ASME B40.100 Grade B
 Process Temp: 0 to 140°F
 Ambient Temp: 0 to 140°F

PSI Range Specifications			
Code	Range	Fig.	Div.
001	30"Hg-0psi	5	1
002	30"-0-15psi	5	0.5
003	30"-0-30psi	10	1
004	30"-0-60psi	10	2
005	30"-0-100psi	20	2
006	30"-0-150psi	25	5
008	30"-0-300psi	50	10
02	0-15psi	2.5	0.5
03	0-30psi	5	1
04	0-60psi	10	2
05	0-100psi	20	2
06	0-160psi	40	5
07	0-200psi	50	5
08	0-300psi	50	10
09	0-400psi	100	10
10	0-600psi	100	20
11	0-1000psi	200	20
19	0-1500psi	300	20
12	0-2000psi	500	50
13	0-3000psi	500	100
14	0-5000psi	1000	100
18	0-6000psi	1000	200
20	0-7500psi	1000	200
15	0-10,000psi	2000	200

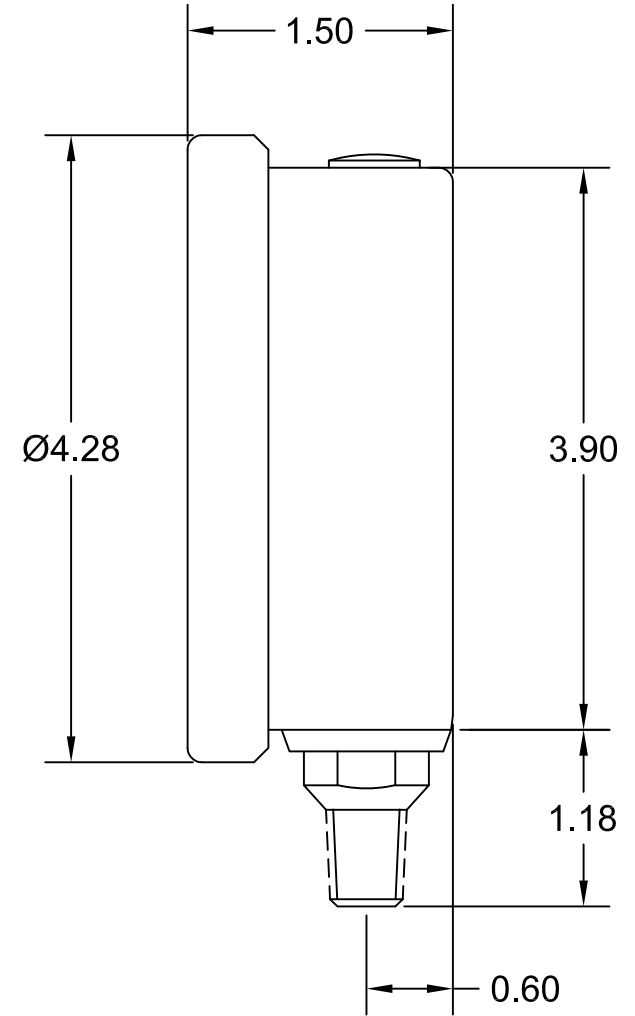
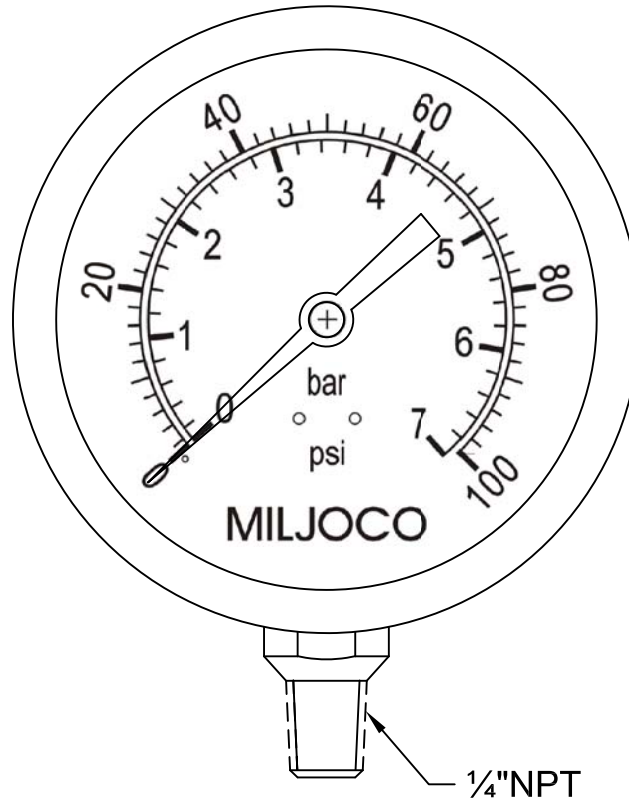

Customer: _____

Project: _____

Engineer: _____

Pro or PO#: _____

MILJOCO			
CORPORATION 200 Elizabeth Street, Mt. Clemens, Michigan 48043 USA			
SCALE:	None	APPROVED BY:	DRAWN BY: HMT
DATE:	8/5/14		REVISED:
4.0" Glycerine Filled Pressure Gauge			
.XX ± .010	.XXX ± .005	MODEL NUMBER: PLF4098L Series	DRAWING NUMBER: 127-329